

MAJAR

USER AND SERVICE INSTRUCTION MANUAL

SPARE PART LIST

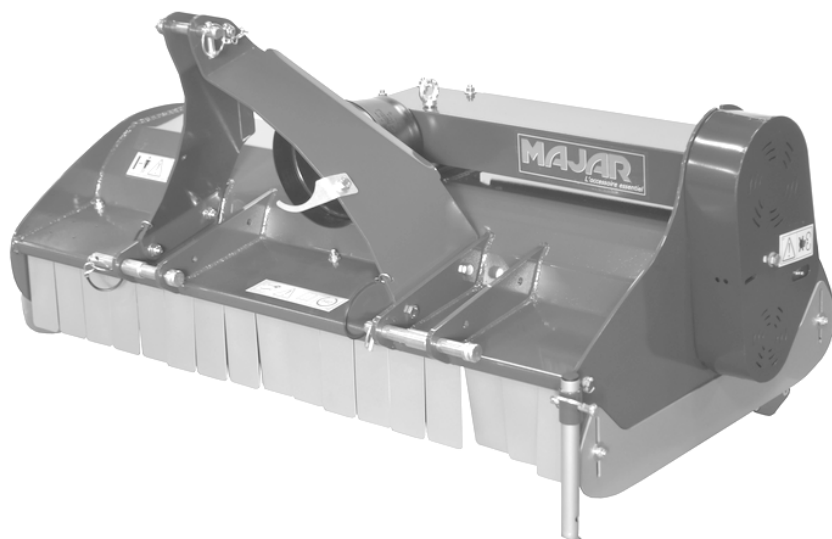

FLAIL MOWER



RBML - RBRM

10/2018

**100 – 115 – 130 – 155
115DG30 – 130DG30 – 155DG30**

Please read the following instructions carefully before operating the machine and refer to them as needed. If you do not understand a part of the user manual, please contact your MAJAR reseller or:

MAJAR S.A
1 Route de Montréal - CS30074
11890 CARCASSONNE Cedex 9
FRANCE
Phone 0033 / 4 68 25 38 16

TABLE OF CONTENTS

FOREWORD.....	2	MAINTENANCE BY USER.....	13
TECHNICAL DATA.....	3	TIGHTENING TORQUE.....	13
INSPECTION CHECKLIST.....	4	MALFUNCTION AND REMEDY.....	16
SAFETY REGULATIONS and PREVENTION.....	5	DECLARATION OF CONFORMITY....	17
INSTALLATION AND COMMISSIONING	9	GUARANTEE.....	18
ADJUSTMENT AND USE.....	11	SPARE PART LIST	19

FOREWORD

Please read this user manual and the manual delivered with the cardan before operating your flail mower, the information allow you ensure quality work in complete safety. If the manual is not clear enough, please contact our technical service.

The security depends on the use of the machine with the limitations explained in this manual.

You have to know and to follow the safety regulations of this manual and of the tractor manual.

The machine you bought was carefully designed and manufactured in order to give you complete satisfaction.

As any mechanical gear, it requires cleaning and maintenance. Lubricate as described. Follow the regulations and safety information given in this manual and on the security stickers of the flail mower and the tractor.

For maintenance your MAJAR reseller has the competency and the original pieces to respond your needs.

Enter below model and serial number of your machine for reference.

MODEL :

SERIAL N°:

In line with the goals of continuous improvement MAJAR reserves the right to change the machines without changing the sold machines. The illustrations and characteristics of this manual may vary slightly on your due to production changes.

No part of this manual may be reproduced, copied or made public by whatever means without authorization of MAJAR.

Throughout the manual the terms “left” “right”, “front” “rear/back” are given referring to the driver’s position. The term IMPORTANT is used to indicate that a failure may cause damages for the machine. The terms WARNING and DANGER are used with safety alert symbols to indicate the degree of safety hazard.



This symbol means: attention, be careful, your safety is involved. It reminds the safety instructions or focuses your attention to dangerous practices which may cause injury or operational occurrence.



WARNING reminds the safety regulations: may cause injury if not observed



DANGER reminds the safety regulations: may cause irreparable, lasting injury or cause death if the good precautions are not taken



GENERALES EMPLOYMENT ISSUES

Model RBML: flail mower with Y knives for gras and light vegetation, can be equipped with paddles for mowing, scarificators or hammers for mincing of thick residu.

This model is adapted to micro tractors for maintenance work with low intensity.

Model RBRM: reinforced model for intense work; steel transmission, drive with 3 belts, rear roll bearings protected and front flaps from sheet metal.

TECHNICAL DATA

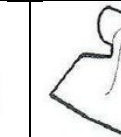
Reference	Recom power HP	Work-ing width cm	PTO speed Tr/min					Weight Kg
				Number of knives				
RBML100	15/30	100	540*	32	16	48	16	155
RBML115	20/35	115	540*	40	20	60	20	165
RBML130	20/45	130	540*	44	22	66	22	175
RBML155	25/45	155	540*	52	26	78	26	195
RBML115DG	20/35	115	540*	40	20	60	20	180
RBML130DG	20/45	130	540*	44	22	66	22	190
RBML155DG	25/45	155	540*	52	26	78	26	210
RBRM 115	25/50	115	540*	40	20	60	20	175
RBRM 130	25/60	130	540*	44	22	66	22	185
RBRM 155	30/60	155	540*	52	26	78	26	205
RBRM 115DG	25/50	115	540*	40	20	60	20	190
RBRM 130DG	25/60	130	540*	44	22	66	22	200
RBRM 155DG	30/60	155	540*	52	26	78	26	220

*Rotation direction of joint shaft of the tractor: clockwise when standing in front of tractor output shaft
Gearbox with freewheel - Transmission with 2 or 3 belts – rotor speed: 2500 tr/mn.

Montage on 3 point rear linkage n°1 – power grip *ASAE 1 3/8" - 6 splines*

Option : *slid kit patins ref. KPATRBM*

Airborne-noise and vibrations: the sound pressure level on the driver position is inferior to 70dB(A). The vibrations transmitted to the driver of the tractor are insignificant.

HANDLING OF THE MACHINE

The machine is equipped with a lifting ring for chain clevis.
Take note of the weight indications on the data table to use the right lifting devices.

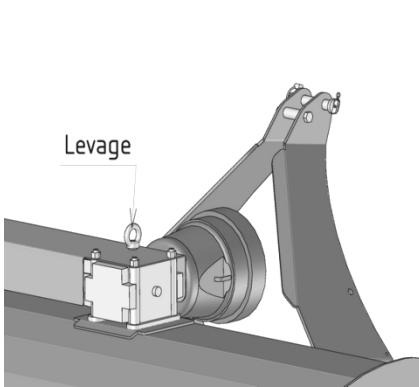

WARNING

The operator who carries out the lifting operations of the machine must be competent to use devices for mechanical/electric lifts (bridge crane, forklifts, cranes,). He must be formed also for the use of individual protective equipment and et liftign and transport modes to ensure the safety of other persons, animals or further.

INSPECTION CHECKLIST

The assembly, installation and commissioning of the machine is the MAJAR reseller's responsibility.
Please read carefully the use and care manual and the safety regulations. Make sure that the indicated points of the checklist had been verified before delivery and on delivery and amended if necessary before delivering the machine to the owner.

INSPECTIONS BEFORE DELIVERY

- Check that all the safety screens, grids and safety measures are in place and in good condition
- Check that all screws and bolts are tightened to the right torque value (see table)
- Make sure that the safety stickers are in place and in good condition
- Check the oil level in the angular gearbox (recommended oil 80w90, GL4 or 5).
- Check the other lubrication points, apply new grease if necessary
- Check that the machine is operating correctly
- Check transmission status.

VERIFICATIONS AT DELIVERY

- Show the client how to mount the machine and how to realize the tool adjustments
- Explain the importance of lubrication and show him the lubrication points
- Show him les safety devices, safety measures and options
- Present the use and instruction manual to the client as well as the specific cardan manual, ask to read it.
- Explain to the client to use the adequate signage when driving on the road.

SAFETY REGULATIONS



WARNING

Some illustrations may show the machine without protective screen or shield. Never use the machine without these devices.

- *Learn how to stop the machine in emergency situation. Read this manual and the tractor manual*
- *Never let anyone else use this machine if the person did not read and understand this manual*
- *It is absolutely forbidden to transport persons or animals on the machine*
- *Never let children use this machine*
- *Always wear protective equipment for head, ears, hands and feet using this machine*
- *Stay away from the rotor when the machine is in use.*
- *Always wear close-fitting clothing to avoid to be snatched by the moving parts or to hang on*
- *Clean the worksite from branches, stones or debris which may be projected and cause injury or damage*
- *Always work on daylight or with good artificial light*
- *Make sure that the safety stickers are in place and in good condition*
- *Clean the grass and debris accumulations*
- *Make sure that the machine is in good working condition before using it.*
- *Make sure that all the safety screens, grids and safety measures are in place and in good condition*
- *Do not use the machine in areas where you cannot keep safety distance from the persons or animals to avoid projection injury*
- *If the tractor has a ROPS Roll Over Protective Structure, fasten your seat belt*
- *Make sure that nobody or anything is behind you while backing off*
- *Do not start or stop the engine abruptly on slopes*
- *Do not use the machine on too big slopes*
- *Reduce speed on slopes to avoid a loss of control*
- *Be careful while driving along embankments or ditches*
- *Pay attention to the holes or other area accidents on undulating terrains*
- *Stop the machine before crossing roads, pathways or ways with gravel.*
- *Disengage the power grip, stop the motor, apply the handbrake and remove the key before all settings, adjustments, maintenance or disassembly*
- *Never let anyone else to the driver's cab during adjustment interventions, maintenance or disassembly of the machine*
- *Check periodically tightening torques of all fasteners*
- *While maneuvering on slope always work up and down, never across the slope.*
- *Place the wheels according to the setting increase stability of the tractor.*
- *Avoid unstable embankments, rocks and holes; this can be dangerous when moving*
- *Avoid aerial cables, high-voltage lines and obstacles. Contact with power lines causes electrocution and death.*
- *Activate all the safety equipment*
- *Only operate the control panel when you are correctly seated in front*
- *Check visually hydraulic leaks and missing or faulty parts. Repair when necessary before every manoeuvre*
- *Check with the competent authorities that the linkage complies with the national legislation when driving on roads.*

WARNING

It is strictly forbidden to remove the safety stickers and symbols specifying danger. Missing or damaged stickers must be replaced immediately. Contact your MAJAR reseller.

The information illustrated by these symbols must be necessarily respected. The noncompliance with these rules may cause death or serious injuries.

1

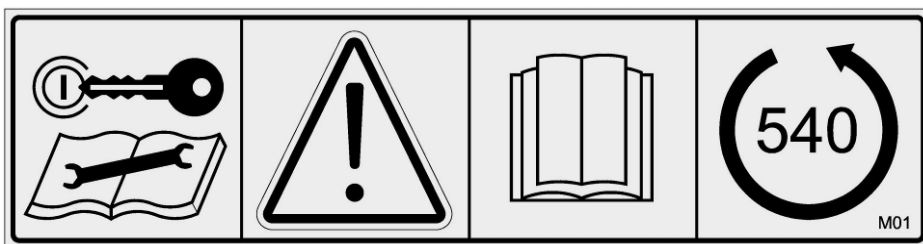

ATTENTION

Stop the tractor and remove the key before adjustment or maintenance operation

Read carefully the manual before operating the machine.

Check the power grip speed and direction of rotation before setting up the drive shaft.

2

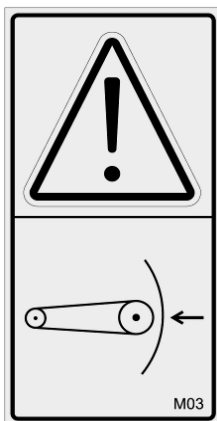

ATTENTION

Transmission, moving parts, do not remove the guard.

3



ATTENTION

Move away from the machine. Danger of thrown objects.

Moving parts, risk of hand injuries, risk of foot injuries

4



ATTENTION

Move away from the machine. Danger of ejected objects.

Keep all safety devices in place during operation.

EMPLACEMENT OF THE SAFETY STICKERS AND THE IDENTIFICATION PLATE

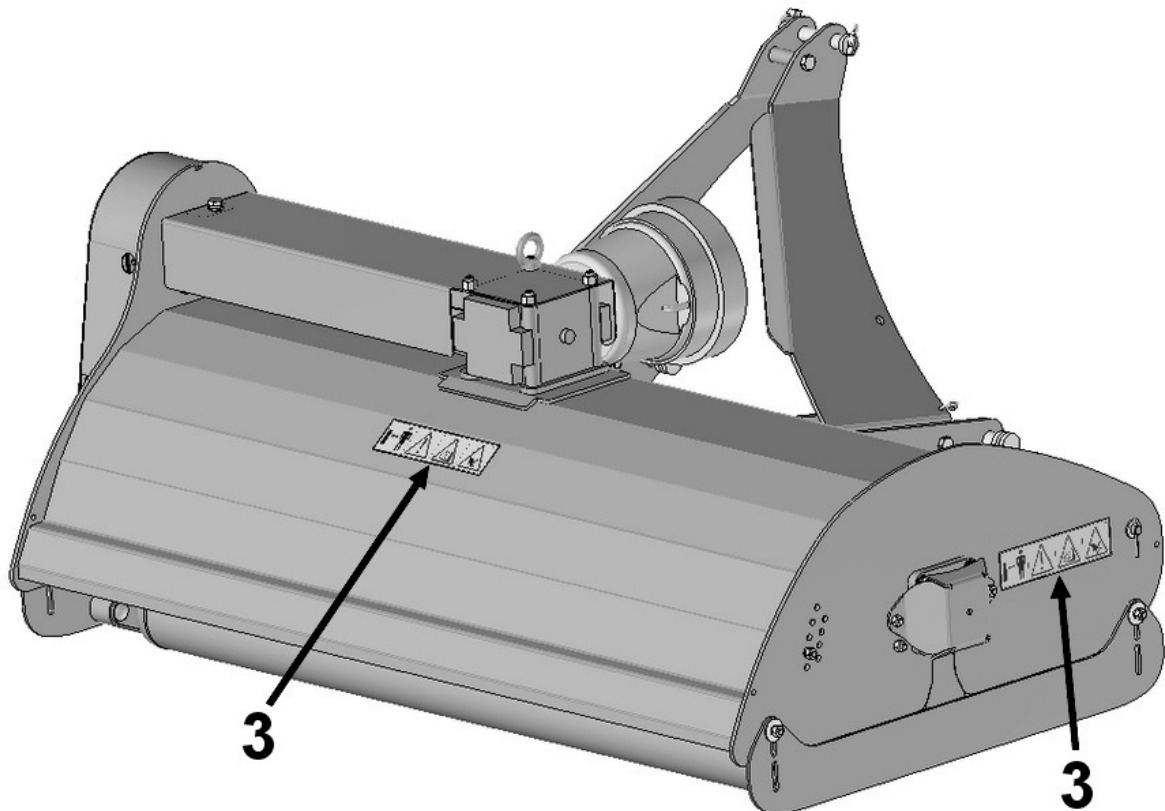
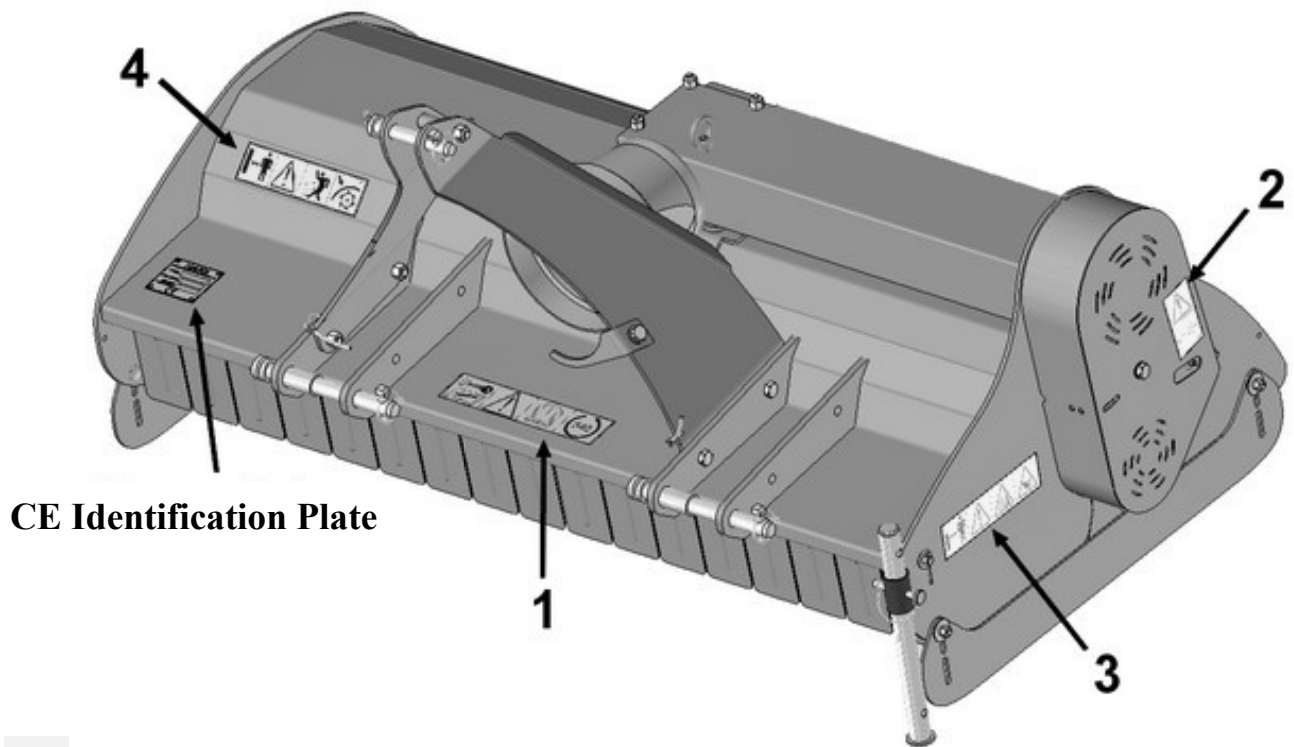

PROTECTION DEVICE AGAINST THE RISKS CAUSED BY MOVING PARTS



DANGER

It is absolutely forbidden to use the machine without protection devices against work accidents. The protection devices must be maintained in good operating conditions and immediately replaced if damaged.

Only use original MAJAR spare part pieces.

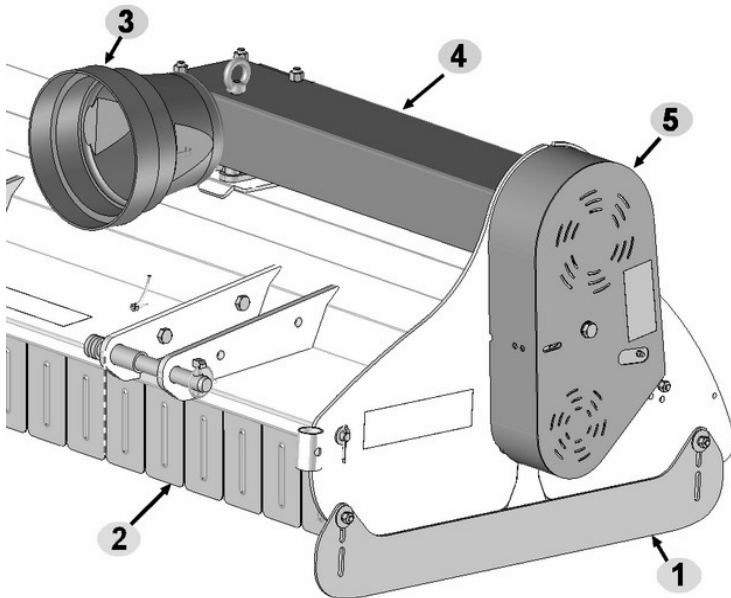

1 – Lateral Protections:

The machine has two lateral protections fixed on the two sides of the chassis. The height is adjusted to avoid accidental contact between the operator and the moving tools.

These protections must be adjusted based on the chosen cutting height, so that the distance between soil and protection **does not exceed 3 cm**.

The protections can be replaced by optional slides (« P »).

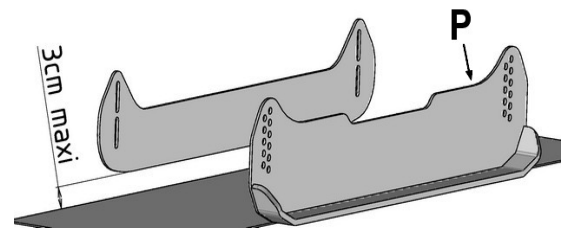

2 – Front protection strips anti-spatter (Fig.2):

The machine has protection strips made of steel to avoid the projection of objects like pebbles, wood pieces... . **Make sure before each use that the strips pivot freely on the fixation axle.**

3 – Drive shaft protection:

The gearbox has a protection limiting access to moving pieces of transmission. Please refer to the separate instructions of cardan shaft for adjustment and fixation of protections.

4 – Lateral drive shaft protection :

5 – Drive belt protection:

Rear protection:

The rear roller for cutting height adjustment is also a protection. Do not use the machine without the roller.

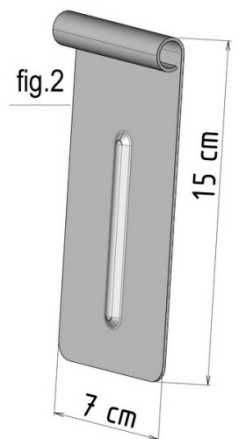

INSTALLATION AND COMMISSIONING

The installation and commissioning of the tool are the responsibility of the MAJAR reseller. The rotary slasher must be delivered fully mounted, lubricated and adjusted to the normal operating conditions.



DANGER Make sure that the characteristics of the tractor are adapted for the machine, particularly the power, lift capacity, linkage type, speed and rotation direction of the power grip. Please read this notice, the cardan manual the tractor notice completely prior to use.



WARNING Always wear safety footwear, protection equipment for eyes, ears and hands when climbing onto the machine. Do not allow anyone to sit on the driving position when mounting the machine.

Montage without offset

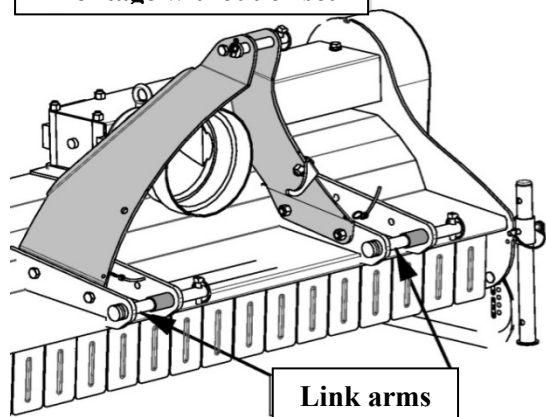

Montage with 11 cm offset

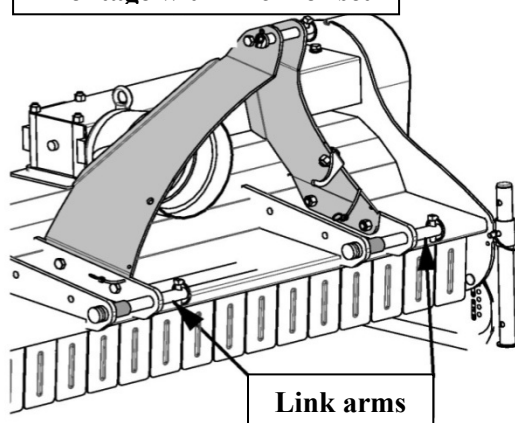

*Versions
RBML
RBRM*

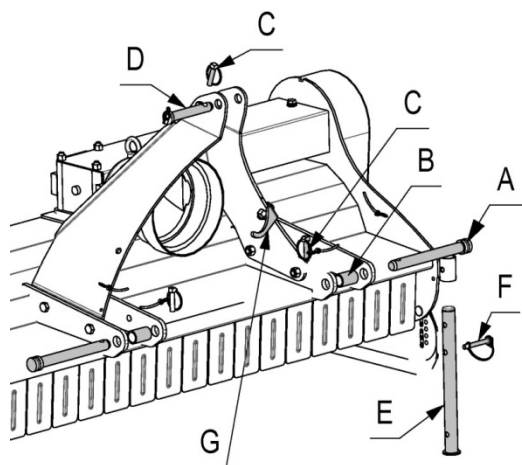

COUPLING OF THE MACHINE

- Remove the axles and the rings « A » and « B » (models RBML and RBRM).
- Move back the tractor until the lower arms are at a few cm of each side of the linkage axles.
- Stop the engine, shift the transmission to neutral, apply the handbrake and remove the key.
- Couple the axles and the rings « A » and « B » (models RBML and RBRM).
- Couple the lower arms directly on the axles (models DG).
- Secure the axles with pins « C ». Adjust the arm tensioners of the tractor so that the transversal offset is about 4 cm.
- Place the cardan transmission (see paragraph « **cardan shaft setting up** »).
- Couple the 3° point linkage securing with axle « D » and pin « C ». **Adjust the rod length of 3° point so that the output shaft of the angular gearbox is parallel with the ground.**

- Lift the machine, use the crutch « E » and secure with pin « F ».

UNCOUPLING OF THE MACHINE



WARNING The machine must be stored in an area sheltered from bad weather on a firm and level ground. Do not put the output shaft of the flail mower on the floor.

Proceed in vice versa order, disconnect the transmission on tractor side, put on support « G » to maintain it over ground level.

CARDAN SHAFT SETTING UP



DANGER More detailed information in the specific manual of the cardan which is an initial part of the safety documentation to read carefully. In the event of a discrepancy with the following, follow the instructions given in the specific manual of the du cardan. The cardan must have CE marking.



WARNING The safety devices (Freewheel, friction torque clutch ...) must be imperatively placed nearby the machine.

Adjust the length of the transmission :

Make sure that the transmission is in the shortest linkage position and the remaining travel must be about 4 cm. Cut the drive shaft if necessary, cut the protectors about 0.5 cm to facilitate the assembly.

Cardan disassembled and fully input, determine the length « L0 » of the tubes. With the machine on the tractor, make sure that the transmission is at the longest linkage position, the remaining travel must be 15 cm and at least half of « L0 » in this position.

Lubricate the tube sliding before assembly.

These operations are normally detailed in the specific cardan manual.

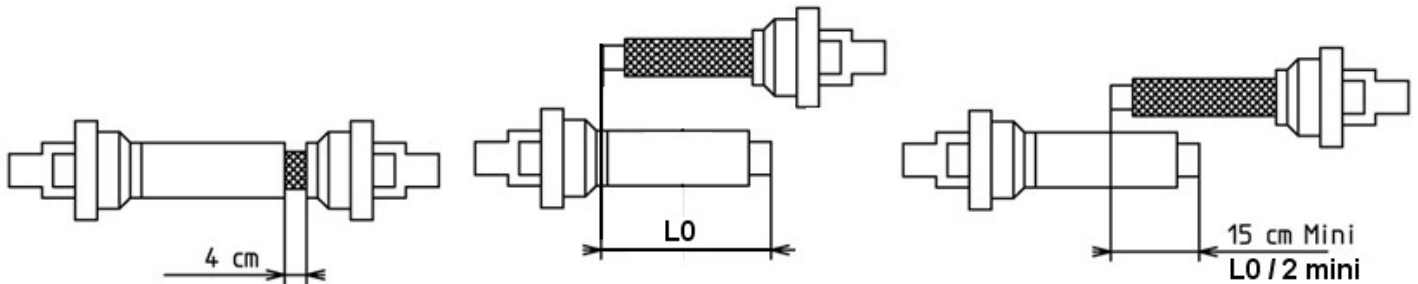

Setting up the transmission :

Connect the transmission to tracteur, check the locking device is locked in the shaft. Connect in the same way the tractor and check that both ends of the cardan are locked. Attach the protectors of the transmission on the tractor and tool so that they will not turn with the transmission.



Check that no parts of the mower deck or the tractor get in contact with the transmission when lifting the machine. Check that you do not reach the maximum angle of the transmission

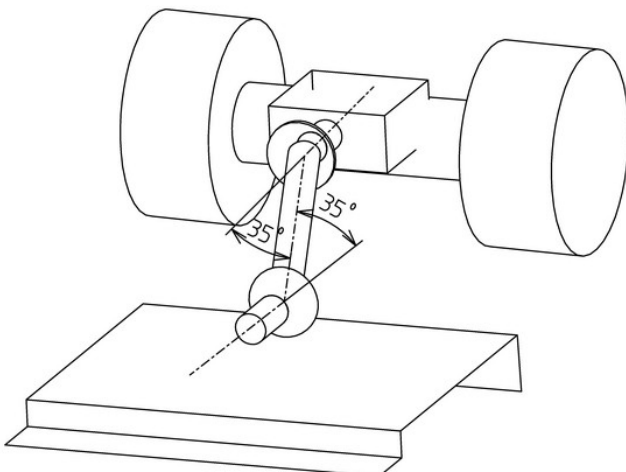

NEVER EXCEED THE MAXIMUM ANGLE OF THE TRANSMISSION

ADJUSTMENT AND USE



Check the tightening of the bolts; see table tightening torque at the end of the manual. Check the presence and fixation of safety equipment (carter, bol ...).

The safety is a challenge that concerns the most while designing and manufacturing this tool. However, the efforts of the constructor may be shattered due to user carelessness. The accident prevention depends on prudence and training of staff in charge of using and maintenance of the machine. The best safety device is a careful and informed user; we ask you to be this user.

The user of this machine is responsible for the use and safety. The user has to be qualified and trained to the machine and he also has to know the tractor. Read all the safety instructions.



WARNING

Never use the machine without having done the operations described in chapter « daily maintenance ».

This machine is designed to cut lawn. It is not designed to be hitched to inappropriate power and weight engines, to work on excessively pebbly ground, to cut hard objects, stones, garbage. It should not be used to transport persons or material.



DANGER

The following operations must be only and exclusively done when the engine is switched off, handbrake applied. If necessary lift the machine, place the supports to prevent from falling or failure of the lifting of the tractor.

- ADJUSTMENT OF CUTTING DEPTH:

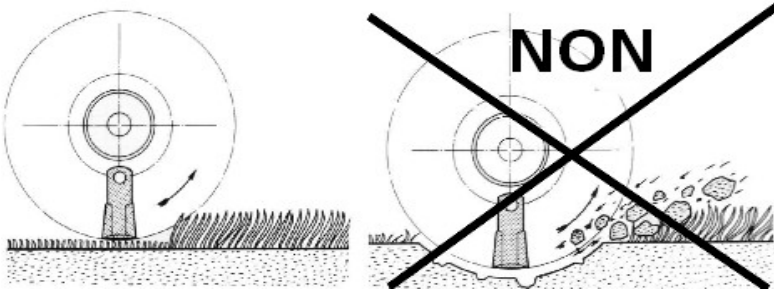

The cutting height must be adjusted depending on the desired result. A good setting means power and fuel saving and reduces machine wear.

To adjust the working height, change rear roller position « 1 » : Remove the 2 screws « 4 ».

- Position the roller at the desired height and replace and lock the screws « 4 ».
- Remove the screws « 2 » and « 3 », adjust the deflector height at 2 - 3 cm from the ground and lock the screws.

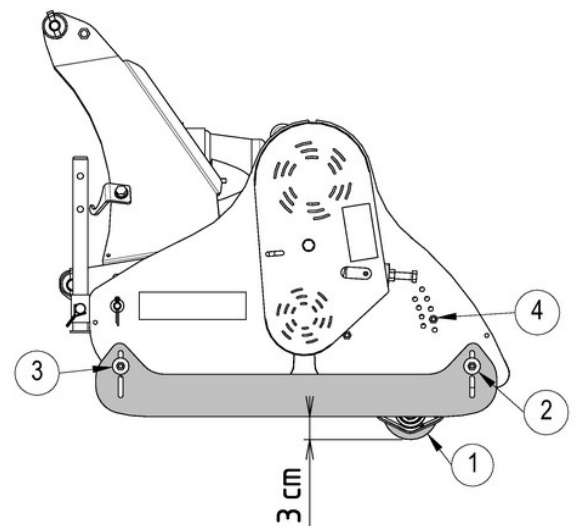

MANUAL OFFSET ADJUSTMENT **(RBMLDG/RBRMDG) :**

- 1/ Stop the engine, shift the transmission to neutral, apply the handbrake and remove the key.
- 2/ Remove the indexing axle and the pin (A).
- 3/ Pull up the lever (B), and push or pull the machine laterally to obtain the desired offset (4 positions, 5 / 15 / 25 / 35cm).
- 4/ Make sure that the lever (B) is fully engaged, and replace the indexing axle and the pin (A).

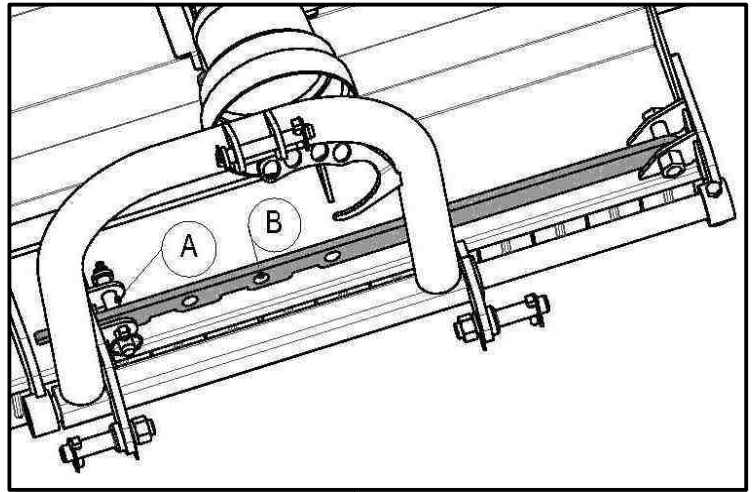

HYDRAULIC OFFSET ADJUSTMENT **(DGH30) :**

- Adjust the excess flow valve to obtain a moderate offset speed. A speed that is too high can lead to deterioration of the mechanism.

Unfasten the locknut « E », Screw the locking ring direction « B » to increase the flow or unscrew the locking ring in direction « A » to reduce the flow.

• USE :

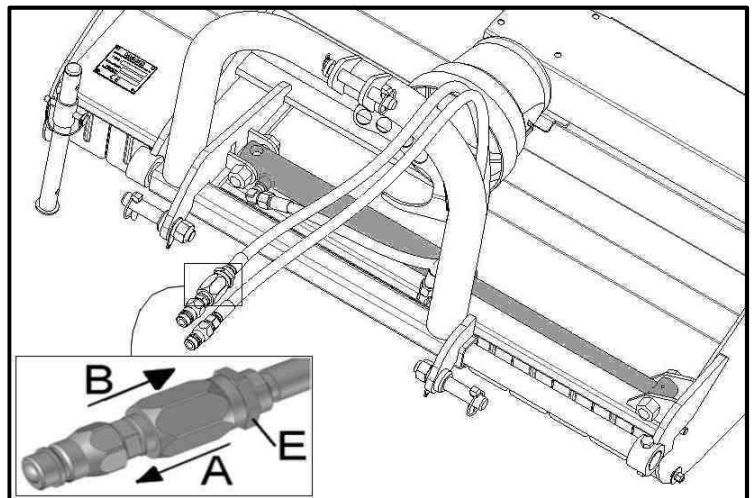

WARNING

Always wear close-fitting clothing to avoid to be snatched by the moving parts. Use safety footwear and protective equipment for eyes, ears and protection from the dust.

Do not start the machine when lifted. Lower on the ground and lift a few centimeters before connecting power grip with the motor idling. Lower the machine in work position. Increase the engine speed until the nominal speed indicated on the dashboard of the tractor.

• Speed

The recommended working speed is between 5 and 10 km/h. It depends on the height and the nature of the cutted grass.



DANGER

Be careful about the abnormal vibrations or noise during use. The rotation speed is very high and each rotor is equipped with knives after montage. Any deterioration or loss of knives will lead to an imbalance of the rotor and cause vibrations, a quick deterioration of the machine and danger to people. Stop the engine immediately.

MAINTENANCE BY USER



DANGER

Prior to maintenance or repair work on the machine, stop the engine, apply the handbrake and remove the key. Never let anyone else to the driver's cab. If lifting the machine is necessary, place the supports to prevent falls or failure of the lifting system.

DAILY MAINTENANCE BEFORE STARTING WORK

- Check the condition and fixation of the protections of belts, cardan shaft and angular gearbox.
- Make sure that there are no leaking traces, if not contact your reseller to repair the machine.
- Clean entirely the machine from debris or dirt accumulations which qui reduce performance and can mask failure or leakage.
- Check the presence, fixation and degree of wear of the knives. They should never be twisted, damaged or worn.



WARNING

All knives should be fitted and in good conditions to avoid imbalance on the rotor which could cause vibrations and rapid deterioration of the device. Damaged or twisted knives reduce performances, need more power and can worsen the transmission system and the chassis.

INITIAL USE

- After 2 hours of use, control tightening of all fasteners.

See table Tightening torque



Pay particular attention to the tightening of the 2 pulley hubs: Block the 2 setscrews tightening several times until the exact tightening.

- The first draining must be done after 50 hours. The next one every 500 hours.

EVERY 30 HOURS WORKED

- Control tightening of all fasteners
- Check belt tension (see paragraph « belt tension adjustment »).
- Grease wheel bearings (see paragraph « lubrication »).
- Grease the crosspieces and cardan shaft (see notice of cardan).



Clean the grease gun and use the grease pump. Do not leave excess grease on the pieces

EVERY 100 HOURS WORKED

- Check the oil level of the angular gearbox
- Control the belts of transmission and idler pulley

EVERY 500 HEURES WORKED

- Drain the gearbox.

TIGHTENING TORQUE

Screw diameter (mm)	Wrench size (mm)	Torque setting (daN.m)
8	13	2
9	Hexa. 5 (Hub lower pulley)	3
10	16/17	5
11	Hexa. 5 (Hub higher pulley)	3
12	18/19	8.5
14	21/22	13
16	24	21.5
20	30	43.5

• **BELT TENSION ADJUSTMENT**



Before starting the machine, check and if necessary adjust belt tension. Remove cardan transmission before adjusting belt tension of transmission.

Check tension

Press the belts introducing a screwdriver through the openings A » and check the offset with the light « B ».

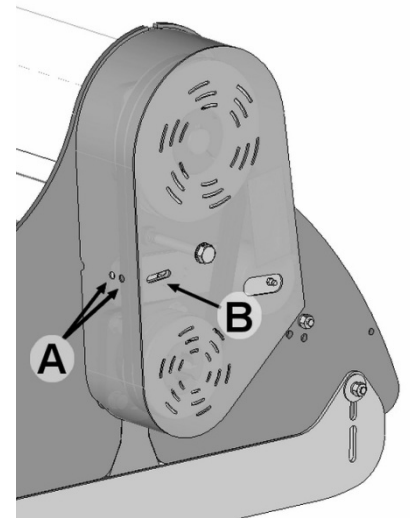
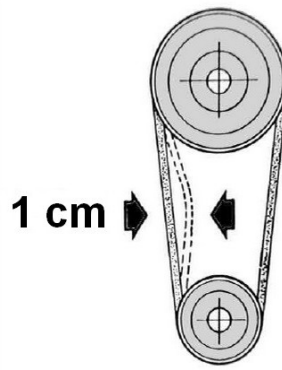
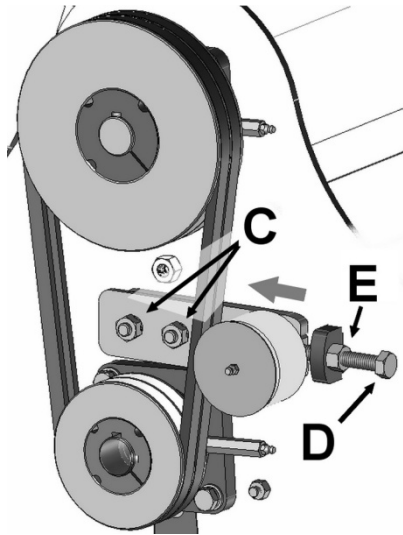

Tension adjustment

Release the 2 nuts « C ».
Loosen the nut « E » maintaining the screw « D ».
Push the tensioning arm screwing « D ».
Block tight the nuts « C » and « E ».

• **LUBRICATION AND GREASE**



WARNING

Do not throw away in natural environment: waste oil, mineral grease and cloths , dusters or paper impregnated with these substances. Drop them into adequate containers or send them to collection centres.



DANGER

To handle oil or mineral grease, use appropriate protections as: “CE” certified protection gloves for oil with the pictograms “CHEMICAL HAZARDS” and “MECHANICAL HAZARDS” as well as glasses to protect you from possible oil or grease splattering.

Angular gearbox:

The first draining must be done after 50 hours. The next one every 500 hours.

Use mineral oil (150VG150 or 80W90 or GL4 or GL5)



Never fill up completely the gearbox

Quantity of oil in gearbox: about 0.5 l

Level: When removing plug, the oil must be just below the hole.

Drainage: Lift and tip the machine with safe and adequate lifting equipment. Remove plug « N » and collect the oil. Put the machine on level ground, fill with oil up to the level and screw the plug.

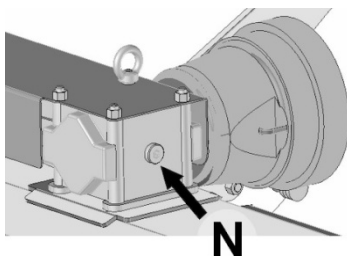

Version RBML

Version RBMR

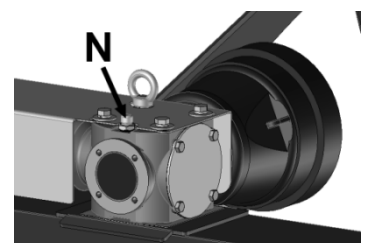

Lubrication points:

Clean meticulously the grease guns before greasing.

Grease slowly and without excessive pressure excessive to avoid damage on sealing. Use lithium grease.

See also the manual of cardan transmission for the librication points and maintenance.

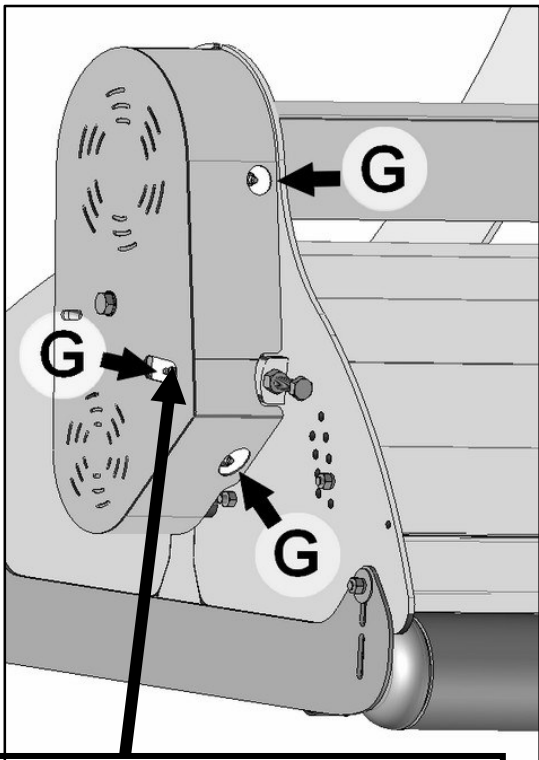

Lubrication depending on versions

Take care to grease moderately at the belt transmission.
Clean the grease in excess which could be projected on the belts and cause skidding or deterioration of transmission elements.

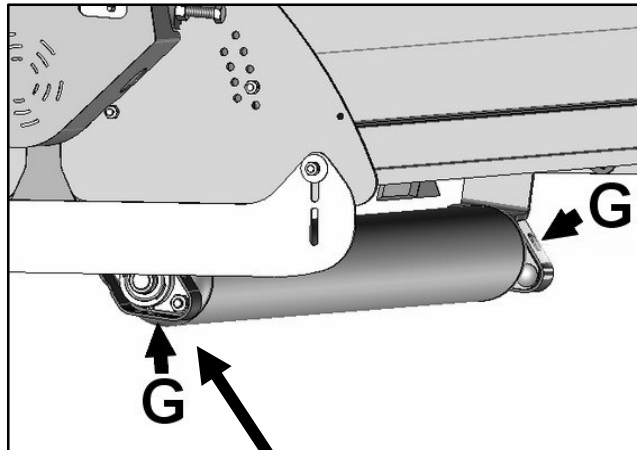

No lubrication on versions RBRM

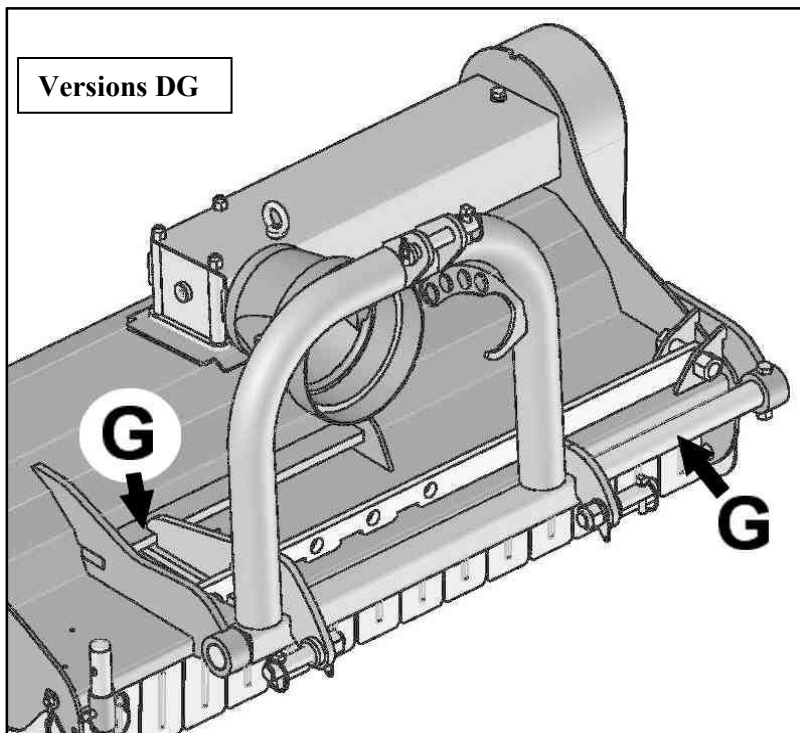

Versions DG

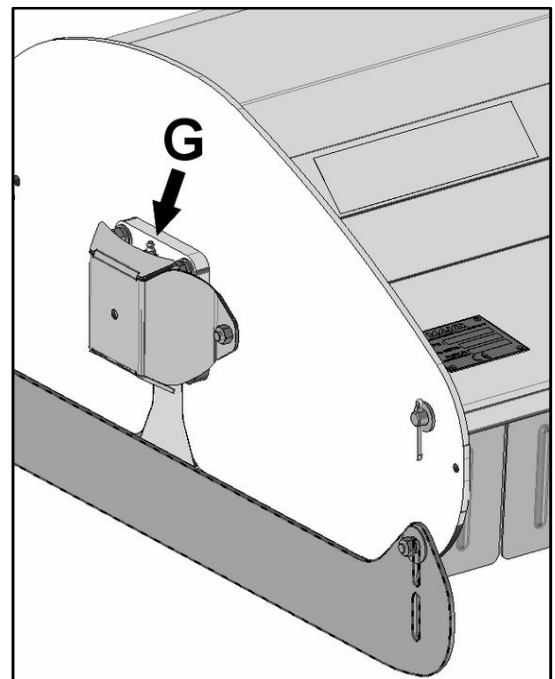

VERSIONS « DG » :

Lubricate regularly the sliding parts of the parties coulissantes: front axle and rear fork.

REPLACEMENT OF KNIVES



WARNING

The blades are sharp and may cause injury, always wear gloves when handling them, be careful not to cut yourself.

Couple the machine to the tractor, set down on the ground on chocks so that the blades turn free.

Stop the engine, apply the handbrake and remove the key.



DANGER

When you replace the blades, you are required to change the locknuts. Contact your MAJAR reseller to obtain original spare parts. Do not replace by other spare parts with different characteristics.

To ensure perfect functioning, a frequent control of the conditions and fixation of spacers and knives is required. If the knives are worn or damaged, replace by new parts remembering the original montage position.

Couple the machine and tractor, place it on the ground on chocks so that the rotor turns freely.

Stop the engine, apply the handbrake and remove the key. Replace the worn knives.

MALFUNCTION AND REMEDY

PROBLEM	CAUSE	REMEDY
Transmission system is noisy	The rotor bearings are worn or damaged	Have the machine controlled by reseller and replace bearings.
	The belts are worn or not bended	Have the machine controlled by reseller , bend the belts or change.
	There is not enough oil in the gearbox	Refill the gearbox as mentionend in the manual
The machine vibrates	The rotor is unbalanced	Check and change damaged knives
	Damaged bearings	Have the machine controlled by reseller
	Wrong rotation speed	Check speed and rotation direction of the power grip
	Damaged cardan shaft	Have the machine controlled by reseller
	Bolt fastening loosened	Retighten bolts
The grass has been badly cut	Forward speed too high	Reduce speed
	Working height too high	Change cutting height
	Knives worn or damaged	Check and change damaged knives
	Grass too wet Belt worn or loose	Mow when grass is dry Tighten or change belt

C.E DECLARATION OF CONFORMITY

The letters **CE** on the identification plate of this machine certify that it is conforming to EC machine directive 2006/42/CE.

MAJAR SA.	
11850 CARCASSONNE TEL: 04 68 25 38 16	
TYPE :	<input type="text"/>
N°de SERIE:	<input type="text"/>
Année de construction	<input type="text"/>
CE	

The Director,
Jean-Luc Checa

GUARANTEE

Each new manufactured by MAJAR SA is guaranteed as follows below, warranted against defects of construction and assembly and/or of the materials when used appropriately during 1 year.

1° This guarantee is limited to 1 year to the replacement of pieces mounted and recognized as faulty by MAJAR.

2° All pieces requested on guarantee must be returned to MAJAR for inspection, reparation or replacement prepaid postage with proof of purchase of the machine, serial number and carefully packed for protection.

3° The machine must not be damaged, repaired or maintained without authorization from MAJAR. The machine must not have had an accident, been misused, abused or used acting not conform instructions and specifications contained in this manual

This guarantee does not oblige MAJAR or representative to reimburse labor costs or transport costs of the machine for reparation.

NO GUARANTEE WILL BE APPLIED TO THIS EXCEPT THE LEGAL WARRANTY FOR HIDDEN DEFECT.

MAJAR CANNOT BE HELD RESPONSIBLE FOR DAMAGES OR COSTS INCURRED BY THE MACHINE FOR PAR EXAMPLE:

1 RENTAL FEES FOR MATERIAL

2 LOST OF SALE

3 EXECUTION OF WORK CARRIED OUT NORMALLY BY THE MACHINE

MAJAR ASSUMES NO OBLIGATION AND DOES NOT ALLOW ANYBODY TO ASSUME ANY OTHER OBLIGATION THAN THEM IN THE 3 PREVIOUS PARAGRAPHS.

To obtain the name of reseller, contact:

MAJAR S.A
1 Route de Montréal
CS30074
11890 CARCASSONNE Cedex 9
FRANCE

SPARE PART LIST

According to Article L.111-3 of the Consumer Code and of the Decree implementing the Code N°2014-1482 of 9th of December 2014, the availability duration of indispensable spare parts for use of MAJAR material is **7 years**.

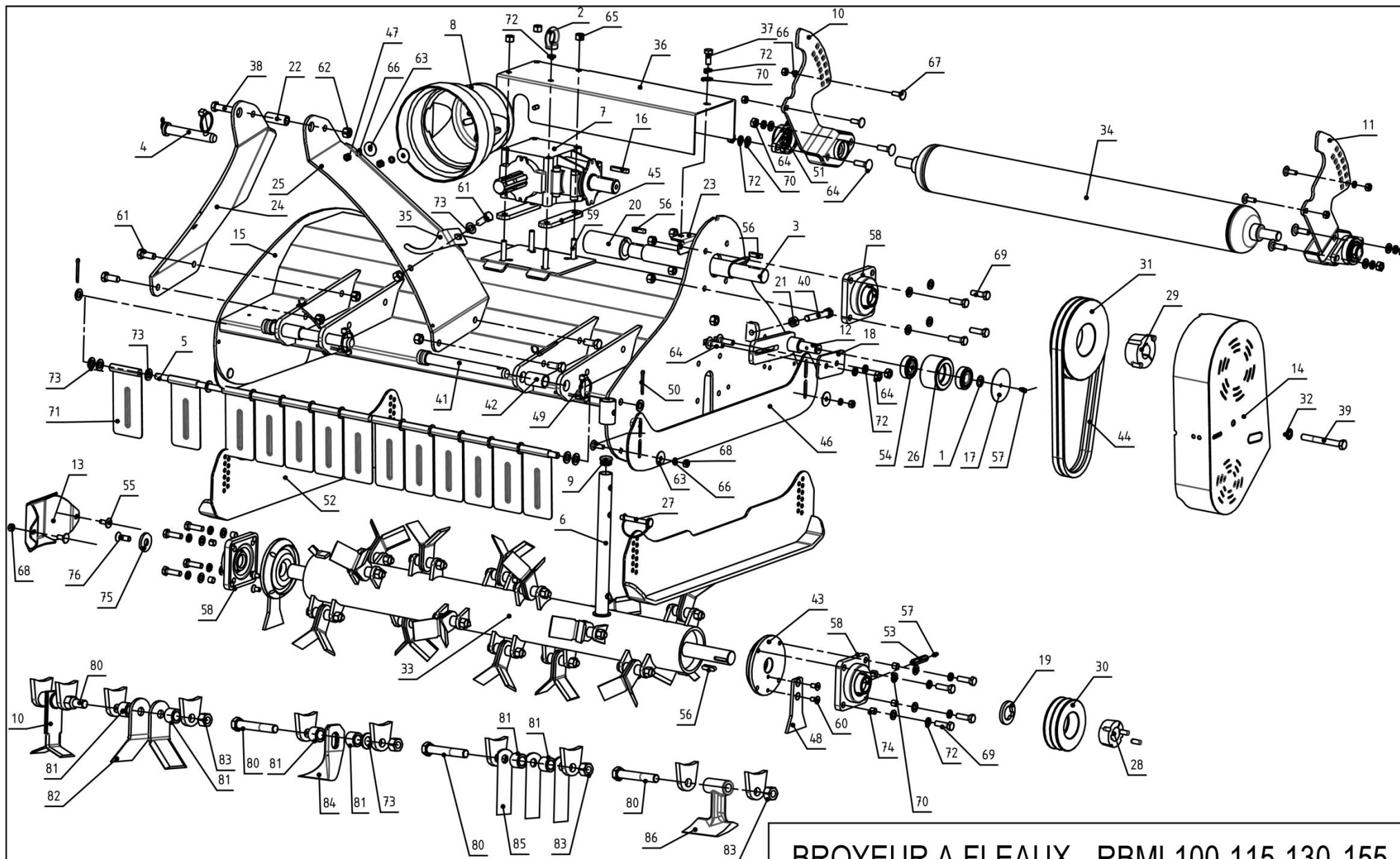

BROYEUR A FLEAUX RBML100-115-130-155

MAJAR

ROUTE DE MONTRÉAL BP.1017 Tel. 04 68 25 38 16
11850 CARCASSONNE CEDEX 9 Fax. 04 68 72 51 61

05/2017

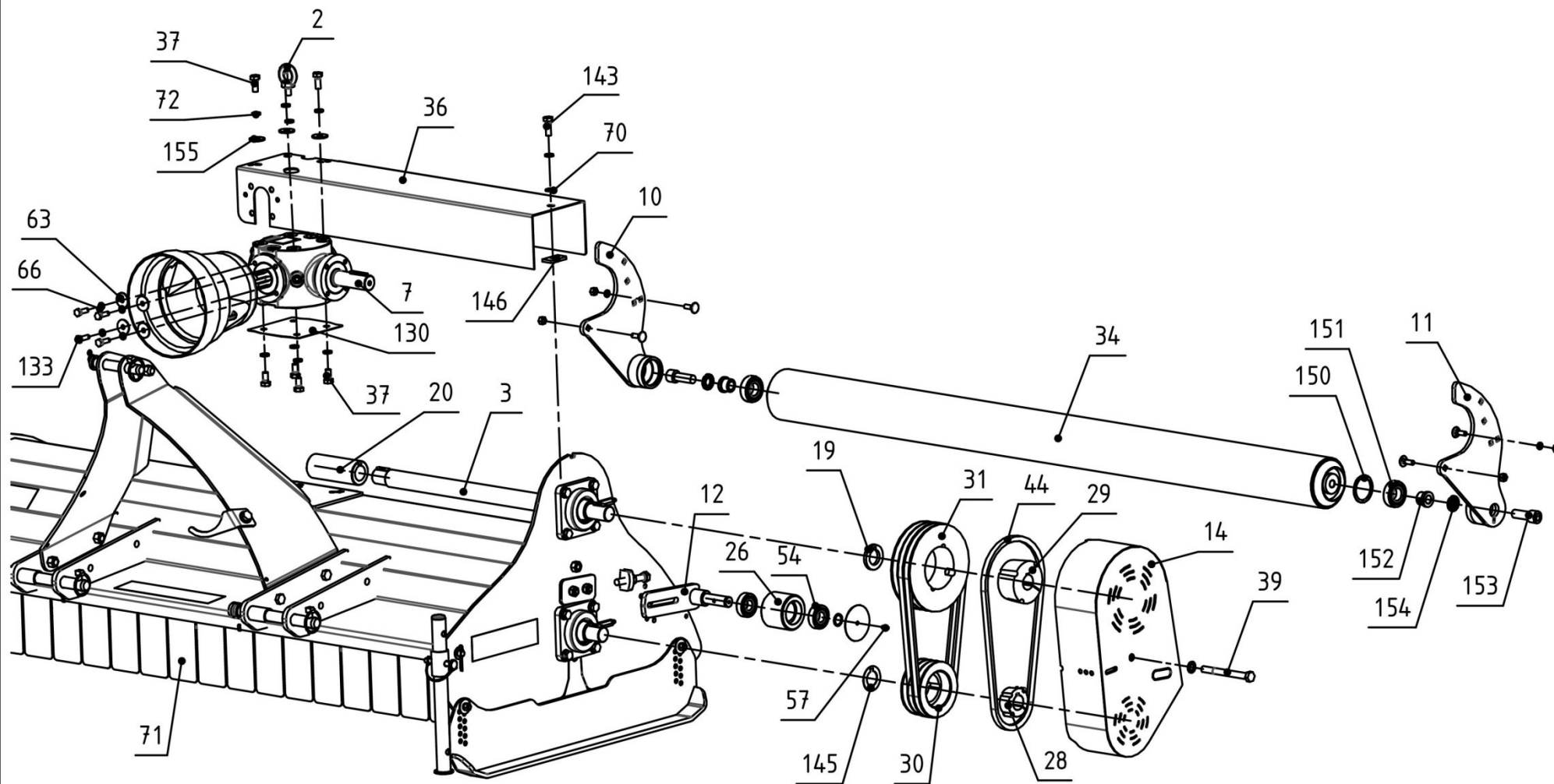

RBRM BROYEUR PROFESSIONNEL

MAJAR

1 ROUTE DE MONTRÉAL
11000 CARCASSONNE

Tel. 04 68 25 38 16
Fax. 04 68 72 51 61

19/07/2018

REP	Ref	Designation	RBML 100	RBML 115	RBML 130	RBML 155	RBML115DG30	RBML130DG30	RBML155DG30	RBRM 115	RBRM 130	RBRM 155	RBRM 115DG30	RBRM 130DG30	RBRM 155DG30
1	9970114	SNAP RING 20	1	1	1	1	1	1	1	1	1	1	1	1	1
2	082761	RING FEM. M10	1	1	1	1	1	1	1	-	-	-	-	-	-
	082830	RING MAL. M10	-	-	-	-	-	-	-	1	1	1	1	1	1
3	186269	SHAFT DRIVE 100	1	-	-	-	-	-	-	-	-	-	-	-	-
	186268	SHAFT DRIVE 115	-	1	-	-	1	-	-	-	-	-	-	-	-
	186609	SHAFT DRIVE 115 RBRM	-	-	-	-	-	-	-	1	-	-	1	-	-
	186267	SHAFT DRIVE 130	-	-	1	-	-	1	-	-	-	-	-	-	-
	186608	SHAFT DRIVE 130 RBRM	-	-	-	-	-	-	-	-	1	-	-	1	-
	186511	SHAFT DRIVE 155	-	-	-	1	-	-	1	-	-	-	-	-	-
	186607	SHAFT DRIVE 155 RBRM	-	-	-	-	-	-	-	-	-	1	-	-	1
4	144101	UPPER AXLE+PIN	1	1	1	1	2	2	2	1	1	1	2	2	2
5	186294	FLAP AXLE RBML100	1	-	-	-	-	-	-	-	-	-	-	-	-
	186295	FLAP AXLE RBML115	-	1	-	-	1	-	-	1	-	-	1	-	-
	186296	FLAP AXLE RBML130	-	-	1	-	-	1	-	-	1	-	-	1	-
	186508	FLAP AXLE RBML155	-	-	-	1	-	-	1	-	-	1	-	-	1
6	582397	CRUTCH RDM + RBML	1	1	1	1	1	1	1	1	1	1	1	1	1
7	082754	GEARBOX T281J M2.91 ALU	1	1	1	1	1	1	1	-	-	-	-	-	-
	082808	GEARBOX WG20 M2.87 STEEL	-	-	-	-	-	-	-	1	1	1	1	1	1
8	082714	PROTECTION CUP	1	1	1	1	1	1	1	1	1	1	1	1	1
9	082664	PLUG 20/27	1	1	1	1	1	1	1	1	1	1	1	1	1
10	582546	RIGHT ARM RBML	1	1	1	1	1	1	1	-	-	-	-	-	-
	582580	RIGHT ARM RBMLAC	-	-	-	-	-	-	-	1	1	1	1	1	1
11	582547	LEFT ARM RBML	1	1	1	1	1	1	1	-	-	-	-	-	-
	582581	LEFT ARM RBMLAC	-	-	-	-	-	-	-	1	1	1	1	1	1
12	582548	SUPPORT IDLER RBML	1	1	1	1	1	1	1	-	-	-	-	-	-
	582628	SUPPORT IDLER RBRM	-	-	-	-	-	-	-	1	1	1	1	1	1
13	186315	EXT. BEARING COVER	1	1	1	1	1	1	1	1	1	1	1	1	1
14	582556	BELT COVER RBML	1	1	1	1	1	1	1	-	-	-	-	-	-
	582629	BELT COVER RBRM	-	-	-	-	-	-	-	1	1	1	1	1	1
15	582553	CHASSIS RBML100	1	-	-	-	-	-	-	-	-	-	-	-	-
	582554	CHASSIS RBML115	-	1	-	-	-	-	-	1	-	-	-	-	-
	582558	CHASSIS RBML115 DG	-	-	-	-	1	-	-	-	-	-	1	-	-
	582555	CHASSIS RBML130	-	-	1	-	-	-	-	-	1	-	-	-	-
	582559	CHASSIS RBML130 DG	-	-	-	-	-	1	-	-	-	-	-	1	-
	582607	CHASSIS RBML155	-	-	-	1	-	-	-	-	-	1	-	-	-
	582609	CHASSIS RBML155 DG	-	-	-	-	-	-	1	-	-	-	-	-	1
16	082752	PIN // 8 X 7 LG.45	1	1	1	1	1	1	1	1	1	1	1	1	1
17	186292	IDLER COVER	1	1	1	1	1	1	1	1	1	1	1	1	1
18	186311	PRESSURE PLATE	1	1	1	1	1	1	1	1	1	1	1	1	1
19	186299	CALAGE POULIE INF.	1	1	1	1	1	1	1	1	1	1	1	1	1
20	186284	DOUILLE RAINURÉE RBML	1	1	1	1	1	1	1	-	-	-	-	-	-
	186606	DOUILLE RAINURÉE RBRM	-	-	-	-	-	-	-	1	1	1	1	1	1
21	9900215	NUT H M12	1	1	1	1	1	1	1	1	1	1	1	1	1

REP	Ref	Designation	RBML 100	RBML 115	RBML 130	RBML 155	RBML115DG30	RBML130DG30	RBML155DG30	RBRM 115	RBRM 130	RBRM 155	RBRM 115DG30	RBRM 130DG30	RBRM 155DG30
22	185125	SPACER 3PTS	1	1	1	1	-	-	-	1	1	1	-	-	-
23	582549	BRACKET SUPPORT CARTER	1	1	1	1	1	1	1	1	1	1	1	1	1
24	186318	RIGHT FLANK	1	1	1	1	-	-	-	1	1	1	-	-	-
25	186319	LEFT FLANK	1	1	1	1	-	-	-	1	1	1	-	-	-
26	186266	IDLER RBML	1	1	1	1	1	1	1	-	-	-	-	-	-
	186611	IDLER RBRM	-	-	-	-	-	-	-	1	1	1	1	1	1
27	082540	PIN Ø10*80	1	1	1	1	1	1	1	1	1	1	1	1	1
28	082756	LOWER HUB Ø30	1	1	1	1	1	1	1	1	1	1	1	1	1
29	082809	UPPER HUB Ø30-3G	-	-	-	-	-	-	-	1	1	1	1	1	1
	082755	UPPER HUB Ø30-2G	1	1	1	1	1	1	1	-	-	-	-	-	-
30	082759	PULLEY 2G DIAM.106	1	1	1	1	1	1	1	-	-	-	-	-	-
	082811	PULLEY 3G DIAM.106	-	-	-	-	-	-	-	1	1	1	1	1	1
31	082758	PULLEY 2G DIAM.170	1	1	1	1	1	1	1	-	-	-	-	-	-
	082810	PULLEY 3G DIAM.170	-	-	-	-	-	-	-	1	1	1	1	1	1
32	9908050	WASHER CONTACT Ø12	1	1	1	1	1	1	1	1	1	1	1	1	1
33	582543	ROTOR 100 NON BALANCED	1	-	-	-	-	-	-	-	-	-	-	-	-
	582544	ROTOR 115 NON BALANCED	-	1	-	-	1	-	-	1	-	-	1	-	-
	582545	ROTOR 130 NON BALANCED	-	-	1	-	-	1	-	-	1	-	-	1	-
	582605	ROTOR 155 NON BALANCED	-	-	-	1	-	-	1	-	-	1	-	-	1
34	582540	ROLLER AR RBML100	1	-	-	-	-	-	-	-	-	-	-	-	-
	582541	ROLLER AR RBML115	-	1	-	-	1	-	-	-	-	-	-	-	-
	582542	ROLLER AR RBML130	-	-	1	-	-	1	-	-	-	-	-	-	-
	582608	ROLLER AR RBML155	-	-	-	1	-	-	1	-	-	-	-	-	-
	582577	ROLLER AR RBMLAC 115	-	-	-	-	-	-	-	1	-	-	1	-	-
	582578	ROLLER AR RBMLAC 130	-	-	-	-	-	-	-	-	1	-	-	1	-
	582611	ROLLER AR RBMLAC 155	-	-	-	-	-	-	-	-	-	1	-	-	1
35	185435	SUPPORT TRANSM.	1	1	1	1	-	-	-	1	1	1	-	-	-
36	582551	PROTEC SHEET RBML115	-	1	-	-	1	-	-	-	-	-	-	-	-
	582550	PROTEC SHEET RBML100	1	-	-	-	-	-	-	-	-	-	-	-	-
	582552	PROTEC SHEET RBML130	-	-	1	-	-	1	-	-	-	-	-	-	-
	582606	PROTEC SHEET RBML155	-	-	-	1	-	-	1	-	-	-	-	-	-
	186302	PROTEC SHEET RBRM115	-	-	-	-	-	-	-	1	-	-	1	-	-
	186303	PROTEC SHEET RBRM130	-	-	-	-	-	-	-	-	1	-	-	1	-
	186509	PROTEC SHEET RBRM155	-	-	-	-	-	-	-	-	-	1	-	-	1
37	9962011	SCREW H 10X25/25	1	1	1	1	1	1	1	7	7	7	7	7	7
38	9961970	SCREW H 12X80/30 - 8/8	1	1	1	1	-	-	-	1	1	1	-	-	-
39	9961980	M12x120/30Cl. 8.8	-	-	-	-	-	-	-	1	1	1	1	1	1
	9961911	SCREW H 12X100/30 CL.8-8	1	1	1	1	1	1	1	-	-	-	-	-	-
40	9961981	SCREW H 12X80/80 - CL.8.8	1	1	1	1	1	1	1	1	1	1	1	1	1
41	082667	AXLE Ø22 L=200	2	2	2	2	-	-	-	2	2	2	-	-	-
42	082668	RING Ø22/28 L=44	2	2	2	2	-	-	-	2	2	2	-	-	-
43	186297	GRASS JAM PROTECTION	2	2	2	2	2	2	2	2	2	2	2	2	2
44	082751	BELT XPA 932 HFX+	2	2	2	2	2	2	2	3	3	3	3	3	3

REP	Ref	Designation	RBML 100	RBML 115	RBML 130	RBML 155	RBML115DG30	RBML130DG30	RBML155DG30	RBRM 115	RBRM 130	RBRM 155	RBRM 115DG30	RBRM 130DG30	RBRM 155DG30
45	186317	CALE BOITIER RBML	2	2	2	2	2	2	2	-	-	-	-	-	-
46	186298	LATERAL DEFFLEC RBML	2	2	2	2	2	2	2	2	2	2	2	2	2
47	9900208	NUT H M8	2	2	2	2	2	2	2	-	-	-	-	-	-
48	186314	FERMETURE COTÉ RBML	2	2	2	2	2	2	2	2	2	2	2	2	2
49	075568	PIN Ø10 + RUBBER	2	2	2	2	2	2	2	2	2	2	2	2	2
50	9907005	PIN V 4/45	2	2	2	2	2	2	2	2	2	2	2	2	2
51	082762	FLANGED BEARING UCFL204	2	2	2	2	2	2	2	-	-	-	-	-	-
52	582557	SKID RBML	2	2	2	2	-	-	-	2	2	2	-	-	-
53	186270	GREASER EXTENSION L50	2	2	2	2	2	2	2	2	2	2	2	2	2
54	082785	BEARING 6204 2RS	2**			2	2**		2	2	2	2	2	2	2
	082760	BEARING 6204 RS	2*	2*	2*	-	2*	2*	-	-	-	-	-	-	-
55	9960707	R HEAD SCREW CC Ø8x20	2	2	2	2	2	2	2	2	2	2	2	2	2
56	082753	PIN KEY // 8 X 7 LG.32	3	3	3	3	3	3	3	3	3	3	3	3	3
57	9907210	RIGHT GREASER M 6X100	4*	4*	4*	3	3*	3*	3	3	3	3	3	3	3
	9908021	WASHER MN 0 6	1*	1*	1*	-	1*	1*	-	-	-	-	-	-	-
	9960603	TAPPING SCREW HM6x12	1**			1	1**		1	1	1	1	1	1	1
58	082757	BEARING SF30 4Ø	3	3	3	3	3	3	3	3	3	3	3	3	3
59	9960708	R HEAD SCREW CC Ø10x140/32	4	4	4	4	4	4	4	-	-	-	-	-	-
60	9960618	COUN SCREW M8x16 CL10.9	4	4	4	4	4	4	4	4	4	4	4	4	4
61	9962017	SCREW H 12X30/30 CL.8.8	5	5	5	5	-	-	-	5	5	5	-	-	-
62	9900510	LOCKNUT M12	6	6	6	6	-	-	-	6	6	6	-	-	-
63	9908009	WASHER LL d=8 XL	6	6	6	6	6	6	6	8	8	8	8	8	8
64	9960700	R HEAD SCREW CC 10x35	6	6	6	6	6	6	6	2	2	2	2	2	2
65	9900504	LOCKNUT M10	7	7	7	7	7	7	7	4	4	4	4	4	4
66	9908073	WASHER W 0 8	8	8	8	8	8	8	8	10	10	10	10	10	10
67	9960706	R HEAD SCREW CC Ø8x25	8	8	8	8	8	8	8	8	8	8	8	8	8
68	9900507	LOCKNUT M8	10	10	10	10	10	10	10	10	10	10	10	10	10
69	9962004	SCREW H 10X35/35	12	12	12	12	12	12	12	12	12	12	12	12	12
70	9908010	WASHER MN 0 10	18	18	18	18	17	17	17	18	18	18	18	18	18
71	582658	REINFORCED FLAP	-	-	-	-	-	-	-	15	17	20	15	17	20
	186293	GALV FLAP RBML	13	15	17	20	15	17	20	-	-	-	-	-	-
72	9908074	WASHER W 0 10	16	16	16	16	16	16	16	20	20	20	20	20	20
73	9908012	WASHER MN 0 12	18	20	22	26	19	21	25	20	22	26	19	21	25
74	082768	STEEL RING 10X12X10	12	12	12	12	12	12	12	12	12	12	12	12	12
75	186411	WASHER	1	1	1	1	1	1	1	1	1	1	1	1	1
76	9960619	COUNT. SCREW FHC M10x30	1	1	1	1	1	1	1	1	1	1	1	1	1
80	9961982	SCREW H 12X80/30 - CL.10.9	16	20	22	26	20	22	26	20	22	26	20	22	26
81	186265	KNIFE SPACER	32	40	44	52	40	44	52	40	44	52	40	44	52
82	082748	KNIFE Y 40X5 Ø12	32	40	44	52	40	44	52	40	44	52	40	44	52
83	9900542	LOCKNUT H M12	16	20	22	26	21	23	26	20	22	26	21	23	26
84	082749	PALETTE TONDEUSE	16	20	22	26	20	22	26	20	22	26	20	22	26
85	082750	SCARIFICATION KNIFE	48	60	66	78	60	66	78	60	66	78	60	66	78
86	082767	HAMMER Ø12.5 RBML	16	20	22	26	20	22	26	20	22	26	20	22	26

REP	Ref	Designation	RBML 100	RBML 115	RBML 130	RBML 155	RBML115DG30	RBML130DG30	RBML155DG30	RBRM 115	RBRM 130	RBRM 155	RBRM 115DG30	RBRM 130DG30	RBRM 155DG30
100	186330	OFFSET STEM	-	-	-	-	1	1	1	-	-	-	1	1	1
101	9900550	LOCKNUT H M20	-	-	-	-	1	1	1	-	-	-	1	1	1
102	186344	SLIDING AXLER BMLDH	-	-	-	-	1	1	1	-	-	-	1	1	1
103	9961912	SCREW H 12X70/30	-	-	-	-	1	1	1	-	-	-	1	1	1
104	9962036	SCREW H 20X80/46 CL.8.8	-	-	-	-	1	1	1	-	-	-	1	1	1
106	582560	POTENCE RBML DG	-	-	-	-	1	1	1	-	-	-	1	1	1
107	080307	CONNECTING ROD AXLE	-	-	-	-	2	2	2	-	-	-	2	2	2
108	185019	PATTE B.I	-	-	-	-	2	2	2	-	-	-	2	2	2
130	186613	SHIM CASING RBRM	-	-	-	-	-	-	-	1	1	1	1	1	1
133	9962002	SCREW H M8x25	-	-	-	-	-	-	-	4	4	4	4	4	4
143	9962012	SCREW H M10x30	-	-	-	-	-	-	-	1	1	1	1	1	1
145	186615	SHIM PULLEY RBRM	-	-	-	-	-	-	-	1	1	1	1	1	1
146	084767	PLATINE SERRAGE POTEAU	-	-	-	-	-	-	-	1	1	1	1	1	1
150	082776	SNAP RING Ø52-Ø55x2	-	-	-	-	-	-	-	2	2	2	2	2	2
151	082777	BEARING 6205-2RS	-	-	-	-	-	-	-	2	2	2	2	2	2
152	186417	L SECTION RING 16-25	-	-	-	-	-	-	-	2	2	2	2	2	2
153	9960509	SCREW CHC M16 X 45 GALV	-	-	-	-	-	-	-	2	2	2	2	2	2
154	9908060	WASHER NORD LOCK 16	-	-	-	-	-	-	-	2	2	2	2	2	2
155	9908006	WASHER LL - 10	-	-	-	-	-	-	-	3	3	3	3	3	3

* Idler mounted with greaser ** Idler mounted without greaser

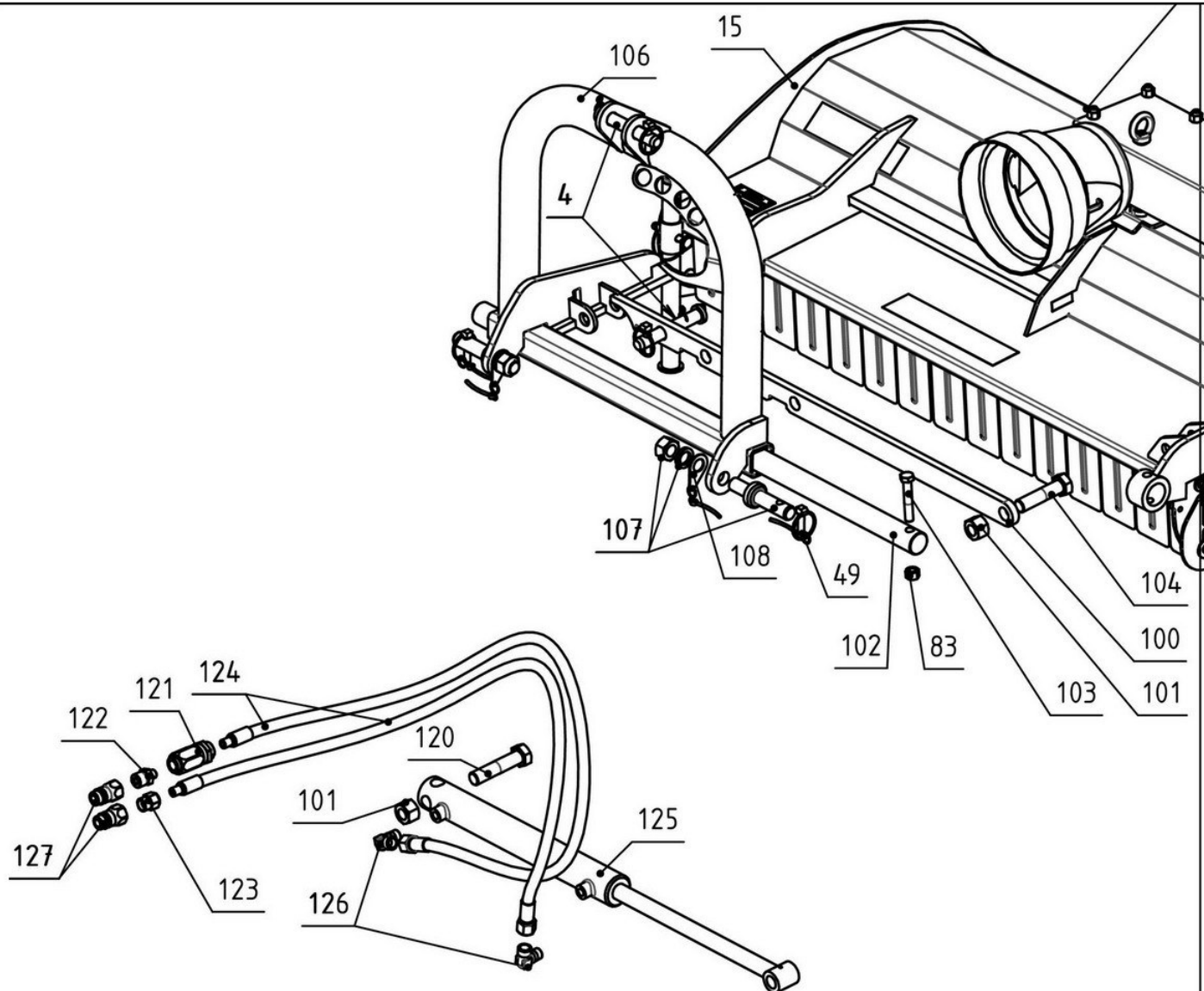

DGH30 - KIT HYDRAULIQUE RBML DG30

Rep.	Référence	Désignation	QTÉ
101	9900550	LOCKNUT H - M20	1
120	9962084	SCREW H - M20 x 90/46	1
121	082686	REGL. VALVE SPH. BIDIRECT.3/8"	1
122	082690	UNION MALE 1/2"G - 3/8" Co	1
123	082705	UNION MALE 1/2"G - F3/8	1
124	082689	HYDR. HOSE 1.5m-ETG13+MC3/8	2
125	082770	DRILLED CYLINDER DE.25/40	1
126	082339	ELBOW FITTING CM13G 3/8G	2
127	082349	COUPLER VALVE Ø20.5 MÂLE	2

VERSIONS RBML DG + OPTION DGH30

MAJAR

ROUTE DE MONTRÉAL BP.1017
11850 CARCASSONNE CEDEX 9

Tel. 04 68 25 38 16
Fax. 04 68 72 51 61

12/2016

MAJAR[®]

1 Route de Montréal
CS30074
11890 CARCASSONNE Cedex 9
FRANCE